



**Welcome Pack**  
Tel Aviv

**#MiCasaEsSuCasa**



A world map in shades of blue. Several countries are highlighted in a darker blue: Spain, France, Germany, Poland, and the United Kingdom. A yellow location marker with a crosshair is placed in the Eastern Mediterranean, near Israel. The text is overlaid on the left side of the map.

# Here you can find useful information

Tel Aviv Training Center

# Meet our AFG management team

AFG is supported by a management team that has decades of flight training experience within the industry. They are experienced aviation training professionals with a proven track record of success in the management and operations of simulation training facilities worldwide.



**ALEJANDRA MIRANDA**  
Director of Operations - Customers  
EUROPE



**SMADAR DAVIDIAN**  
Training Center Coordinator



**MIKHAEL MARTOSEVICH**  
Simulator Maintenance  
Assistant Manager



**IGOR POLIAKOV**  
Simulator Maintenance  
Technician



**STANISLAV FINE**  
Simulator Maintenance  
Technician



**MARTIN BADALIAN**  
Simulator Maintenance  
Technician



**ALEX MAROZ**  
Simulator Maintenance  
Technician





# Get to know our Training Center

- The TLV Training Center opened in 2024 near Tel Aviv's Ben Gurion International Airport. It features one Boeing Full Motion Full Flight Simulator (B787) and a Boeing Fixed Training Device (B787).
- We provide excellent and efficient 24/7 customer service.
- Our facilities are open to all airlines and ATOs worldwide.



# Training Center Facilities

## **Full Flight Simulator (FFS)**

(1) Boeing B787 FFS Level D

## **Flight Training Devices (FTD)**

(1) Boeing B787 FTD Level 4







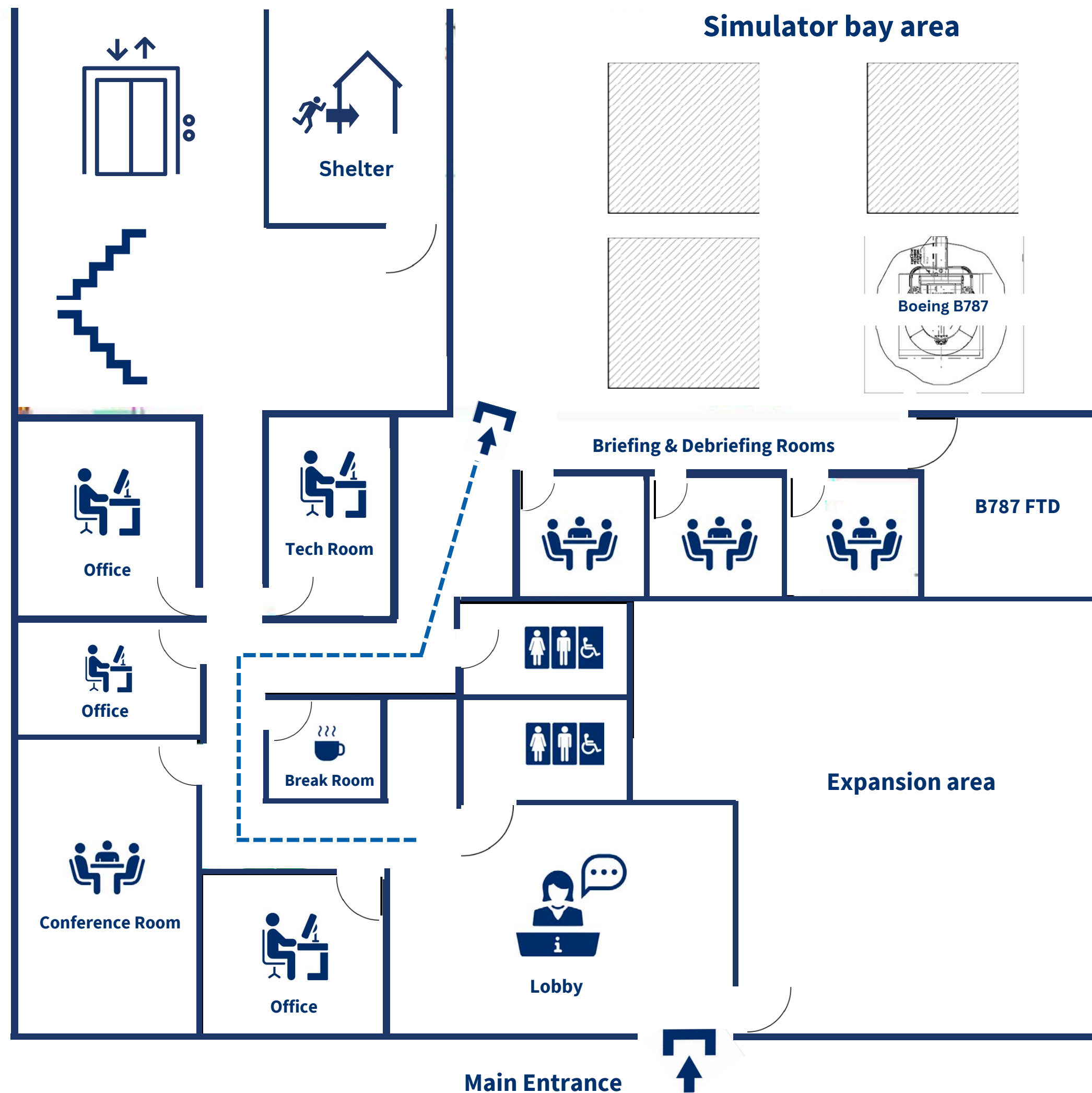

# Map



# How to get to the Training Center



## From Tel Aviv airport

The AFG training center is located just 11 km from Ben Gurion International Airport. You can easily reach the airport by taxi, with the trip costing approximately €20.

AFG can help organize transportation from the airport for you. Please inform us of your arrival at least two days in advance

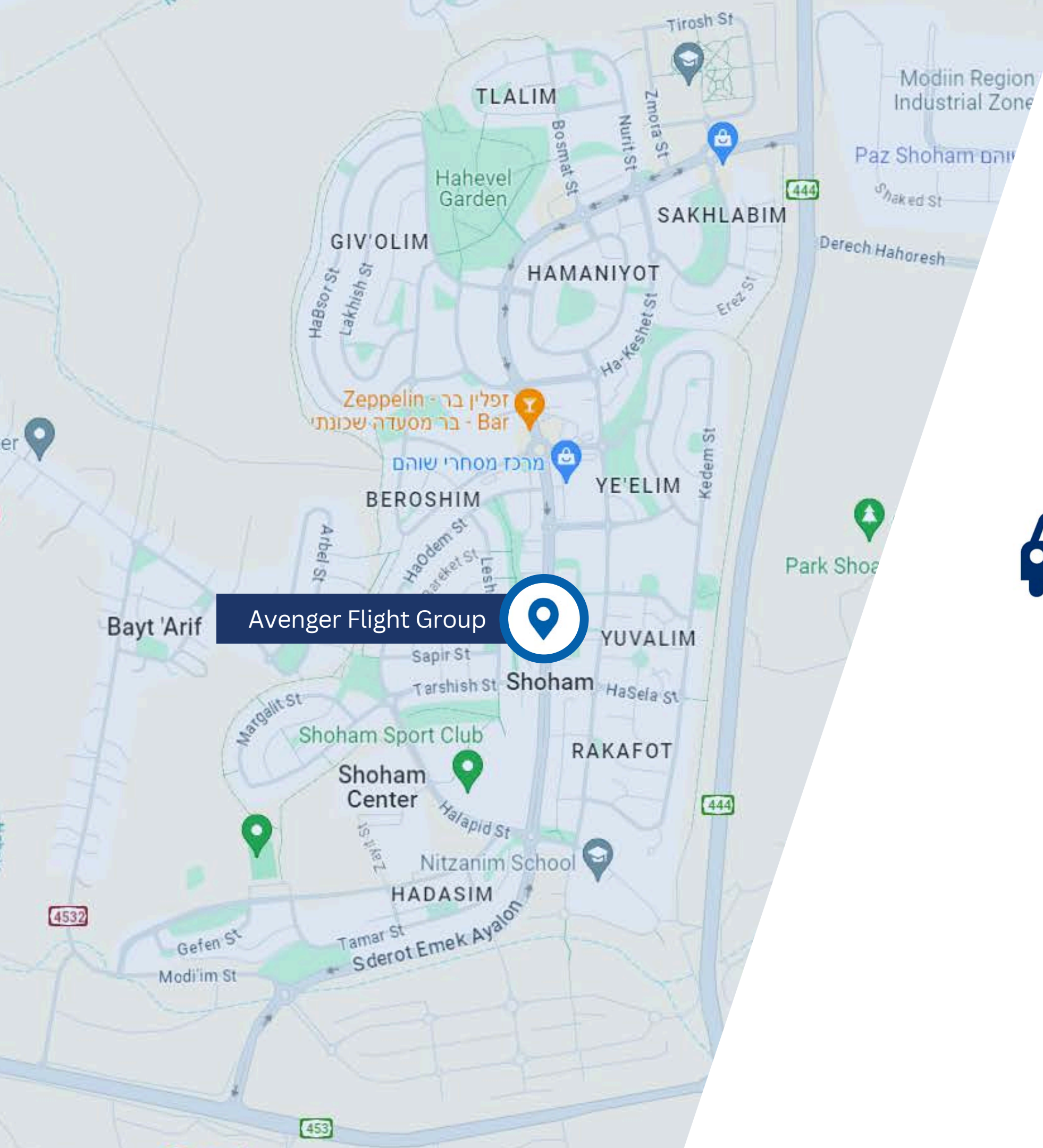



# Lunch ideas



## **Air caffe - Italian restaurant | Harava 2 Airport City**

This restaurant is situated at the center of the business park, surrounded by ponds and waterfalls that lend it a unique character. You can enjoy a variety of hearty breakfast options every morning, business lunches (including fish) during the day, and desserts.

Operating hours:

- Sunday to Thursday: 08:00 to 22:00
- Fridays: 08:00 to 12:30



## **Truman & Co | 1 Ha-yarden Kefar Truman Airport City**

Located just 10 minutes by car from the training center, this restaurant specializes in delicious burgers and salads.

Operating hours:

- Sunday to Thursday: 12:00 to 23:00
- Friday and Saturday: 17:00 to 23:00

# Hotel Accommodations

AFG has fixed negotiated rates with three hotels located in the city:

## **Crown Plaza Hotel - Tel Aviv Beach** | HaYarkon St. 145, Tel Aviv

- Deluxe room (1 guest) with breakfast: ₪970 | €242.50 | \$262
- Executive room + business lounge (1 guest) with breakfast: ₪1100 | €275 | \$300

## **Crown Plaza Hotel - Tel Aviv City Center** | 136 Menahem Begin

- Classic room (1 guest) with breakfast: ₪840 | €210 | \$227
- Deluxe room (1 guest) with breakfast: ₪970 | €242.50 | \$262
- Executive room + business lounge (1 guest) with breakfast: ₪1100 | €275 | \$300

## **Hotel Indigo - Tel Aviv** | Ahliav 5, Ramat Gan

- Classic room (1 guest) with breakfast: ₪600 | €143 | \$163



If you would like AFG to assist you with hotel accommodations in Tel Aviv, please contact us at least two days prior to your arrival.





An aerial photograph of Tel Aviv, Israel, taken during the 'golden hour' of sunset. The city's skyline is visible in the background with several tall skyscrapers. The foreground shows a dense urban area with many smaller buildings. In the bottom left, a large marina is filled with numerous sailboats docked at piers. The sky is a mix of orange, yellow, and blue.

# Discover Tel Aviv

## Tel Aviv Port

Tel Aviv Port encapsulates everything the city has to offer - from the azure sea and tranquil mornings to bustling markets, abundant shops and restaurants, vibrant outdoor events, and a lively nightlife scene with clubs and bars



## Rothschild Boulevard

Rothschild Boulevard is one of Tel Aviv's most dynamic centers. Known for its dining options and vibrant nightlife, Rothschild Boulevard (from Balfour Street southwards) is the perfect place to explore and experience the city.

## Tel Aviv Promenade

It comes to life during the spring and summer, bustling with residents and tourists strolling along the paved pathway and soaking in the stunning views of the Mediterranean Sea.



# Contact info



**Reception phone number: (+972) 3-375-1455**

For access to the training center between 17:00 and 08:00, please call this number.



**Emergency phone 24/7**

+972 50 669 3733



**E-mail**

[info@afgsim.com](mailto:info@afgsim.com)



**Address**

2nd Brosh St., HiPark, Shoham  
6083702 Tel Aviv, Israel





# Tel Aviv Telephone Numbers



## TOURIST INFORMATION

### Tel Aviv City Tourist Office

Independence Trail. Rothschild Blvd 11, Tel Aviv.

+(972) 3 516 6188

[visit.tel-aviv.gov.il](http://visit.tel-aviv.gov.il)

### Tel Aviv Airport Tourist Office

+(972) 3 975 5555



## POLICE

National Police Number: 100

Municipal Police Number: 106



## EMERGENCIES

National Telephone Number: 100 / 101



## HEALTH

Urgencies: 102

Fire Station: 103

Health Emergency Number: 102



## TAXIS

Castel Taxi: \*3242

Hadar Taxi: 09 9711103

Airport Taxi : +(972) 03 381 0008





**#MiCasaEsSuCasa**